



2017 catalog

For CO₂ and fiber laser consumables

Replacements parts suitable for Trumpf®



Our value proposition

- Product breadth – with over 2,800 part numbers
- OEM quality/consistency for nozzles, ceramics and optics
- Technical/application support from OEM-trained technicians
- 100% satisfaction guarantee

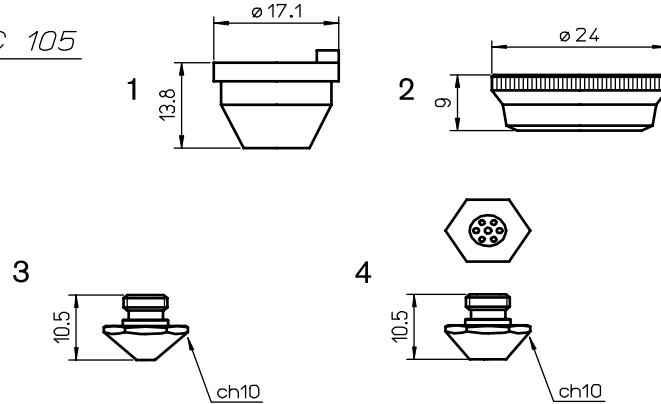

LASER TLC 105

Consumables

	Centricut part number	Reference number	Alternate reference	Description	Pkg qty
1	TR302-2405	280408, 092405	AL53	Nozzle holder – KT M1.5" KN (OEM)	1
2	TR352-0001	280550, P0494-940-00001	AL177	Ring – original (OEM)	1
3	TR302-6939	226939	L211	Nozzle – 1.0 mm	1
	TR302-6939X	226939	L40211	Nozzle – 1.0 mm (10 pack)	10
	TR302-0002		L212	Nozzle – 1.4 mm	1
	TR302-0002X		L40212	Nozzle – 1.4 mm (10 pack)	10
	TR302-0003		L213	Nozzle – 1.7 mm	1
	TR302-0003X		L40213	Nozzle – 1.7 mm (10 pack)	10
	TR302-6933CP	226939	L211X	Nozzle – 1.0 mm CP	1
	TR302-6933CPX	226939	L40211X	Nozzle – 1.0 mm CP (10 pack)	10
	TR302-0002CP		L212X	Nozzle – 1.4 mm CP	1
	TR302-0002CPX		L40212X	Nozzle – 1.4 mm CP (10 pack)	10
	TR302-0003CP		L213X	Nozzle – 1.7 mm CP	1
	TR302-0003CPX		L40213X	Nozzle – 1.7 mm CP (10 pack)	10
	TR302-0001		L214	Nozzle – 1.0 mm HD	1
	TR302-0001X		L40214	Nozzle – 1.0 mm HD (10 pack)	10
	TR302-6940	226940	L215	Nozzle – 1.4 mm HD	1
	TR302-6940X	226940	L40215	Nozzle – 1.4 mm HD (10 pack)	10
	TR302-7144	227144	L216	Nozzle – 1.7 mm HD	1
	TR302-7144X	227144	L40216	Nozzle – 1.7 mm HD (10 pack)	10
	TR302-0001CP		L214X	Nozzle – 1.0 mm HD CP	1
	TR302-0001CPX		L40214X	Nozzle – 1.0 mm HD CP (10 pack)	10
TR302-6949CP	226940	L215X	Nozzle – 1.4 mm HD CP	1	
TR302-6949CPX	226940	L40215X	Nozzle – 1.4 mm HD CP (10 pack)	10	
TR302-7144CP	227144	L216X	Nozzle – 1.7 mm HD CP	1	
TR302-7144CPX	227144	L40216X	Nozzle – 1.7 mm HD CP (10 pack)	10	
4	TR302-7364	237364	L395	Shower nozzle – 1.0 mm	1
	TR302-7364X	237364	L40395	Shower nozzle – 1.0 mm (10 pack)	10

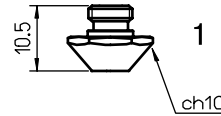
LASER TLC 105



Consumables

	Centricut part number	Reference number	Alternate reference	Description	Pkg qty
	TR302-4230	135420, 1354230	L1150	Nozzle - 0.8 mm	1
	TR302-4230X	135420, 1354230	L401150	Nozzle - 0.8 mm (10 pack)	10
	TR302-2334	212334	L255	Nozzle - 1.0 mm	1
	TR302-2334X	212334	L40255	Nozzle - 1.0 mm (10 pack)	10
	TR302-0008CP	135420, 1354230	L1150X	Nozzle - 0.8 mm CP	1
	TR302-0008CPX	135420, 1354230	L401150X	Nozzle - 0.8 mm CP (10 pack)	10
	TR302-2334CP	212334	L255X	Nozzle - 1.0 mm CP	1
	TR302-2334CPX	212334	L40255X	Nozzle - 1.0 mm CP (10 pack)	10
	TR302-0009		L1151	Nozzle - 0.8 mm HD	1
	TR302-0009X		L401151	Nozzle - 0.8 mm HD (10 pack)	10
	TR302-0004		L270	Nozzle - 1.0 mm HD	1
	TR302-0004X		L40270	Nozzle - 1.0 mm HD (10 pack)	10
	TR302-6199	216199	L256	Nozzle - 1.4 mm HD	1
	TR302-6199X	216199	L40256	Nozzle - 1.4 mm HD (10 pack)	10
	TR302-5213	225213	L257	Nozzle - 1.7 mm HD	1
	TR302-5213X	225213	L40257	Nozzle - 1.7 mm HD (10 pack)	10
	TR302-7009 NEW	1487009	L1147	Nozzle - 2.0 mm HD	1
	TR302-7009X NEW	1487009	L401147	Nozzle - 2.0 mm HD (10 pack)	10
1	TR302-6156	126156	L277	Nozzle - 2.3 mm HD	1
	TR302-6156X	126156	L40277	Nozzle - 2.3 mm HD (10 pack)	10
	TR302-6125		L1149	Nozzle - 2.5 mm HD	1
	TR302-6125X		L401149	Nozzle - 2.5 mm HD (10 pack)	10
	TR302-0027		L1152	Nozzle - 2.7 mm HD	1
	TR302-0027X		L401152	Nozzle - 2.7 mm HD (10 pack)	10
	TR302-0009CP		L1151X	Nozzle - 0.8 mm HD CP	1
	TR302-0009CPX		L401151X	Nozzle - 0.8 mm HD CP (10 pack)	10
	TR302-0004CP		L270X	Nozzle - 1.0 mm HD CP	1
	TR302-0004CPX		L40270X	Nozzle - 1.0 mm HD CP (10 pack)	10
	TR302-6198		L1154	Nozzle - 1.2 mm HD	1
	TR302-6198X		L401154	Nozzle - 1.2 mm HD (10 pack)	10
	TR302-6199CP	216199	L256X	Nozzle - 1.4 mm HD CP	1
	TR302-6199CPX	216199	L40256X	Nozzle - 1.4 mm HD CP (10 pack)	10
	TR302-5213CP	225213	L257X	Nozzle - 1.7 mm HD CP	1
	TR302-5213CPX	225213	L40257X	Nozzle - 1.7 mm HD CP (10 pack)	10
	TR302-6156CP	126156	L277X	Nozzle - 2.3 mm HD CP	1
	TR302-6156CPX	126156	L40277X	Nozzle - 2.3 mm HD CP (10 pack)	10
	TR302-0027CP		L1152X	Nozzle - 2.7 mm HD CP	1
	TR302-0027CPX		L401152X	Nozzle - 2.7 mm HD CP (10 pack)	10

Centricut is not affiliated with the named manufacturers. Reference to machines, parts, descriptions, and model numbers are for convenience in verifying compatibility only. All parts are made by or for Centricut and are not made by the referenced manufacturers (unless expressly indicated). Centricut is a registered trademark of Hypertherm, Inc. All other trademarks are the properties of their respective owners.

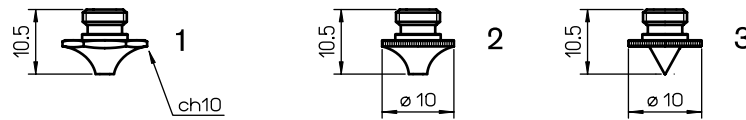
LASER TLC 105

Consumables

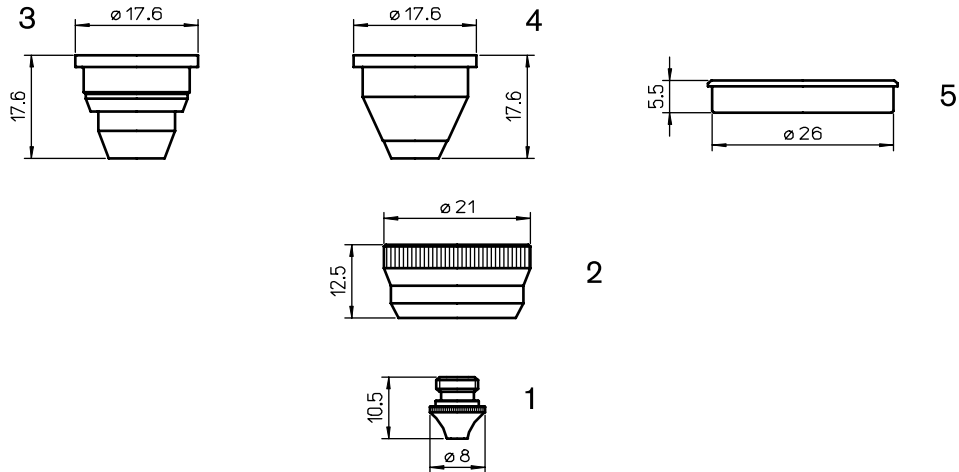
	Centricut part number	Reference number	Alternate reference	Description	Pkg qty
1	TR302-5320		L625	Nozzle - 1.0 mm	1
	TR302-5320X		L40625	Nozzle - 1.0 mm (10 pack)	10
	TR302-5320CP		L625X	Nozzle - 1.0 mm CP	1
	TR302-5320CPX		L40625X	Nozzle - 1.0 mm CP (10 pack)	10
	TR302-0007		L627	Nozzle - 1.0 mm HD	1
	TR302-0007X		L40627	Nozzle - 1.0 mm HD (10 pack)	10
	TR302-5318		L628	Nozzle - 1.4 mm HD	1
	TR302-5318X		L40628	Nozzle - 1.4 mm HD (10 pack)	10
	TR302-0017		L629	Nozzle - 1.7 mm HD	1
	TR302-0017X		L40629	Nozzle - 1.7 mm HD (10 pack)	10
	TR302-0007CP		L627X	Nozzle - 1.0 mm HD CP	1
	TR302-0007CPX		L40627X	Nozzle - 1.0 mm HD CP (10 pack)	10
	TR302-5318CP		L628X	Nozzle - 1.4 mm HD CP	1
	TR302-5318CPX		L40628X	Nozzle - 1.4 mm HD CP (10 pack)	10
	TR302-0017CP		L629X	Nozzle - 1.7 mm HD CP	1
TR302-0017CPX		L40629X	Nozzle - 1.7 mm HD CP (10 pack)	10	
2	TR302-0025		L746	Nozzle - 0.25 mm HD	1
	TR302-0025X		L40746	Nozzle - 0.25 mm HD (10 pack)	10
	TR302-0010	135320	L267	Nozzle - 1.0 mm HD	1
	TR302-0010X	135320	L40267	Nozzle - 1.0 mm HD (10 pack)	10
	TR302-0012		L1153	Nozzle - 1.2 mm HD	1
	TR302-0012X		L401153	Nozzle - 1.2 mm HD (10 pack)	10
	TR302-0014	135318	L268	Nozzle - 1.4 mm HD	1
	TR302-0014X	135318	L40268	Nozzle - 1.4 mm HD (10 pack)	10
	TR302-6157	126157	L269	Nozzle - 1.7 mm HD	1
	TR302-6157X	126157	L40269	Nozzle - 1.7 mm HD (10 pack)	10
	TR302-0010CP	135320	L267X	Nozzle - 1.0 mm HD CP	1
	TR302-0010CPX	135320	L40267X	Nozzle - 1.0 mm HD CP (10 pack)	10
	TR302-0012CP		L1153X	Nozzle - 1.2 mm HD CP	1
	TR302-0012CPX		L401153X	Nozzle - 1.2 mm HD CP (10 pack)	10
	TR302-0014CP	135318	L268X	Nozzle - 1.4 mm HD CP	1
	TR302-0014CPX	135318	L40268X	Nozzle - 1.4 mm HD CP (10 pack)	10
	TR302-6157CP	126157	L269X	Nozzle - 1.7 mm HD CP	1
TR302-6157CPX	126157	L40269X	Nozzle - 1.7 mm HD CP (10 pack)	10	
TR302-0157CPX	126157	L40269X	Nozzle - 1.7 mm HD CP (10 pack)	10	
3	TR302-0747		L747	Nozzle - Sharp tip	1

LASER TLC 1005

Consumables

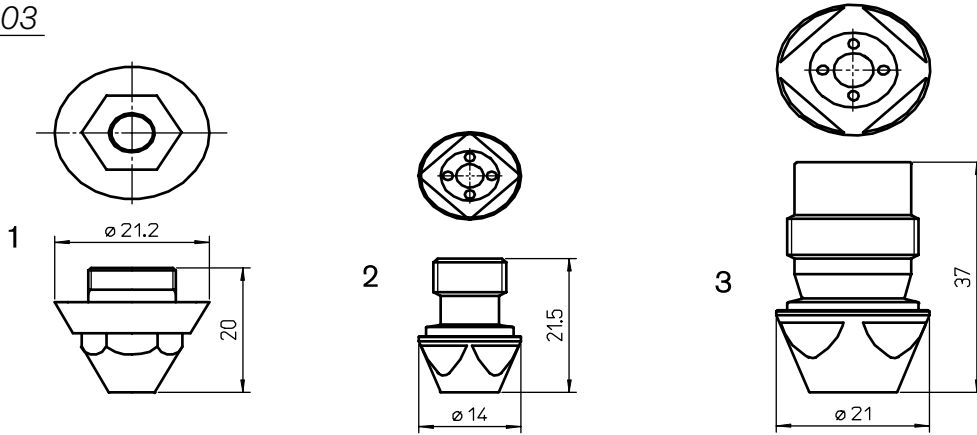
	Centricut part number	Reference number	Alternate reference	Description	Pkg qty
1	TR302-8206	958206	L745	Nozzle - 0.25 mm HD	1
	TR302-8206X	958206	L40745	Nozzle - 0.25 mm HD (10 pack)	10
	TR352-3799	913799	L500	Nozzle - 0.8 mm HD	1
	TR352-3799X	913799	L40500	Nozzle - 0.8 mm HD (10 pack)	10
	TR352-3800	913800	L501	Nozzle - 1.0 mm HD	1
	TR352-3800X	913800	L40501	Nozzle - 1.0 mm HD (10 pack)	10
	TR352-7034	1487034	L498	Nozzle - 1.2 mm HD	1
	TR352-7034X	1487034	L40498	Nozzle - 1.2 mm HD (10 pack)	10
	TR352-3801	913801	L502	Nozzle - 1.4 mm HD	1
	TR352-3801X	913801	L40502	Nozzle - 1.4 mm HD (10 pack)	10
	TR352-7988	937988	L503	Nozzle - 1.7 mm HD	1
	TR352-7988X	937988	L40503	Nozzle - 1.7 mm HD (10 pack)	10
	TR352-7991		L499	Nozzle - 1.75 mm HD	1
	TR352-7991X		L40499	Nozzle - 1.75 mm HD (10 pack)	10
	TR352-7990		L508	Nozzle - 2.0 mm HD	1
	TR352-7990X		L40508	Nozzle - 2.0 mm HD (10 pack)	10
	TR352-7989	937989	L504	Nozzle - 2.3 mm HD	1
	TR352-7989X	937989	L40504	Nozzle - 2.3 mm HD (10 pack)	10
	TR352-3799CP	913799	L500X	Nozzle - 0.8 mm HD CP	1
	TR352-3799CPX	913799	L40500X	Nozzle - 0.8 mm HD CP (10 pack)	10
	TR352-3800CP	913800	L501X	Nozzle - 1.0 mm HD CP	1
	TR352-3800CPX	913800	L40501X	Nozzle - 1.0 mm HD CP (10 pack)	10
	TR352-7034CP	1487034	L498X	Nozzle - 1.2 mm HD CP	1
	TR352-7034CPX	1487034	L40498X	Nozzle - 1.2 mm HD CP (10 pack)	10
	TR352-3801CP	913801	L502X	Nozzle - 1.4 mm HD CP	1
	TR352-3801CPX	913801	L40502X	Nozzle - 1.4 mm HD CP (10 pack)	10
	TR352-7988CP	937988	L503X	Nozzle - 1.7 mm HD CP	1
	TR352-7988CPX	937988	L40503X	Nozzle - 1.7 mm HD CP (10 pack)	10
TR352-7990CP		L508X	Nozzle - 2.0 mm HD CP	1	
TR352-7990CPX		L40508X	Nozzle - 2.0 mm HD CP (10 pack)	10	
TR352-7989CP	937989	L504X	Nozzle - 2.3 mm HD CP	1	
TR352-7989CPX	937989	L40504X	Nozzle - 2.3 mm HD CP (10 pack)	10	
2	TR352-3965	913965	AL254	Retainer nut	1
3	TR302-6678C	936678, 913966/00-WO	AL412	Nozzle holder - ceramic	1
4	TR302-6678	936678, 913966/00-WO	AL212	Nozzle holder - ceramic	1
	TR302-66780EM	936678, 913966/00-WO		Nozzle holder - ceramic	1
5	TR302-0354	960354	AL389	Insulator - PTFE*	1

*PolyTetraFluoroEthylene is a fluorocarbon-based polymer and is commonly abbreviated PTFE. The Teflon® brand of PTFE is manufactured only by DuPont and is not sold by Hypertherm. Hypertherm purchases other brands of PTFE from various high quality manufacturers.

TLF 6003

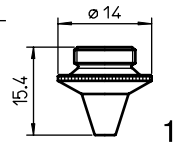
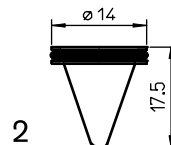
Consumables

	Centricut part number	Reference number	Alternate reference	Description	Pkg qty
1	TR352-2530CP	932530	L1010X	Nozzle - 4.5 mm CP	1
2	TR352-4947	924947	L1185	Nozzle - welding M10	1
3	TR352-0783	220783	L1186	Nozzle - welding M18	1

TESTA YH27

YAG

Consumables

	Centricut part number	Reference number	Alternate reference	Description	Pkg qty
1	PT344-1813	281813, P0589-424-00008	L405	Nozzle - 0.8 mm	1
	PT344-1813X	281813, P0589-424-00008	L30405	Nozzle - 0.8 mm (10 pack)	10
	PT344-1789	281789, P0589-426-00010	L406	Nozzle - 1.0 mm	1
	PT344-1789X	281789, P0589-426-00010	L30406	Nozzle - 1.0 mm (10 pack)	10
	PT344-1561	281561, 778550	L404	Nozzle - 1.2 mm	1
	PT344-1561X	281561, 778550	L30404	Nozzle - 1.2 mm (10 pack)	10
	PT344-1499	281814, 149957	L407	Nozzle - 1.5 mm	1
	PT344-1499X	281814, 149957	L30407	Nozzle - 1.5 mm (10 pack)	10
	PT344-0020	P0589-428-00020	L408	Nozzle - 2.0 mm	1
	PT344-0020X	P0589-428-00020	L30408	Nozzle - 2.0 mm (10 pack)	10
	PT344-1813CP	281813, P0589-424-00008	L405X	Nozzle - 0.8 mm CP	1
	PT344-1813CPX	281813, P0589-424-00008	L30405X	Nozzle - 0.8 mm CP (10 pack)	10
	PT344-1789CP	281789, P0589-426-00010	L406X	Nozzle - 1.0 mm CP	1
	PT344-1789CPX	281789, P0589-426-00010	L30406X	Nozzle - 1.0 mm CP (10 pack)	10
	PT344-1561CP	281561, 778550, P0589-425-00012	L404X	Nozzle - 1.2 mm CP	1
	PT344-1561CPX	281561, 778550	L30404X	Nozzle - 1.2 mm CP (10 pack)	10
	PT344-1499CP	281814, 149957	L407X	Nozzle - 1.5 mm CP	1
	PT344-1499CPX	281814, 149957	L30407X	Nozzle - 1.5 mm CP (10 pack)	10
	PT344-0020CP	P0589-428-00020	L408X	Nozzle - 2.0 mm CP	1
	PT344-0020CPX	P0589-428-00020	L30408X	Nozzle - 2.0 mm CP (10 pack)	10
2	TR414-0008	12-11-16-00	L507	Nozzle - 0.8 mm Yag w/o-ring	1
	TR414-0010		L506	Nozzle - 1.0 mm Yag w/o-ring	1
	TR414-0012	12-11-09-17/00	L505	Nozzle - 1.2 mm Yag w/o-ring	1

Centricut is not affiliated with the named manufacturers. Reference to machines, parts, descriptions, and model numbers are for convenience in verifying compatibility only. All parts are made by or for Centricut and are not made by the referenced manufacturers (unless expressly indicated). Centricut is a registered trademark of Hypertherm, Inc. All other trademarks are the properties of their respective owners.

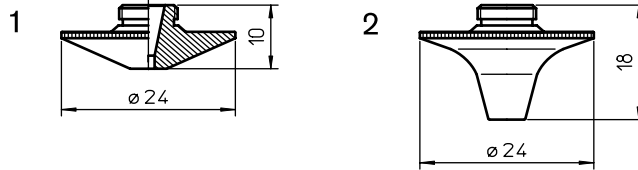
Consumables

	Centricut part number	Reference number	Alternate reference	Description	Pkg qty
	TR301-4561	124561, 237499	L18	Nozzle - 0.8 mm	1
	TR301-4561X	124561, 237499	L3018	Nozzle - 0.8 mm (10 pack)	10
	TR301-4562	124562, 237498	L19	Nozzle - 1.0 mm	1
	TR301-4562X	124562, 237498	L3019	Nozzle - 1.0 mm (10 pack)	10
	TR301-6809	966809	L361	Nozzle - 1.2 mm	1
	TR301-6809X	966809	L30361	Nozzle - 1.2 mm (10 pack)	10
	TR301-0014		L795	Nozzle - 1.4 mm	1
	TR301-0014X		L30795	Nozzle - 1.4 mm (10 pack)	10
	TR301-7500	237500	L26	Nozzle - 1.5 mm	1
	TR301-7500X	237500	L3026	Nozzle - 1.5 mm (10 pack)	10
	TR301-0017		L796	Nozzle - 1.7 mm	1
	TR301-0017X		L30796	Nozzle - 1.7 mm (10 pack)	10
	TR301-7503	237503	L24	Nozzle - 2.0 mm	1
	TR301-7503X	237503	L3024	Nozzle - 2.0 mm (10 pack)	10
	TR301-4564	124564	L797	Nozzle - 2.3 mm	1
	TR301-4564X	124564	L30797	Nozzle - 2.3 mm (10 pack)	10
	TR301-7504	237504	L25	Nozzle - 3.0 mm	1
	TR301-7504X	237504	L3025	Nozzle - 3.0 mm (10 pack)	10
1	TR301-0561CP	352280	L18X	Nozzle - 0.8 mm CP	1
	TR301-0561CPX	352280	L3018X	Nozzle - 0.8 mm CP (10 pack)	10
	TR301-0562CP	352281	L19X	Nozzle - 1.0 mm CP	1
	TR301-0562CPX	352281	L3019X	Nozzle - 1.0 mm CP (10 pack)	10
	TR301-0809CP	352282	L361X	Nozzle - 1.2 mm CP	1
	TR301-0809CPX	352282	L30361X	Nozzle - 1.2 mm CP (10 pack)	10
	TR301-0014CP		L795X	Nozzle - 1.4 mm CP	1
	TR301-0014CPX		L30795X	Nozzle - 1.4 mm CP (10 pack)	10
	TR301-7500CP	352288	L26X	Nozzle - 1.5 mm CP	1
	TR301-7500CPX	352288	L3026X	Nozzle - 1.5 mm CP (10 pack)	10
	TR301-0017CP		L796X	Nozzle - 1.7 mm CP	1
	TR301-0017CPX		L30796X	Nozzle - 1.7 mm CP (10 pack)	10
	TR301-7503CP		L24X	Nozzle - 2.0 mm CP	1
	TR301-7503CPX		L3024X	Nozzle - 2.0 mm CP (10 pack)	10
	TR301-4564CP	124564	L797X	Nozzle - 2.3 mm CP	1
	TR301-4564CPX	124564	L30797X	Nozzle - 2.3 mm CP (10 pack)	10
	TR301-7504CP	237504	L25X	Nozzle - 3.0 mm CP	1
	TR301-7504CPX		L3025X	Nozzle - 3.0 mm CP (10 pack)	10
2	TR301-7497	237497	L20	Nozzle - 1.4 mm HD	1
	TR301-7497X	237497	L3020	Nozzle - 1.4 mm HD (10 pack)	10
	TR301-1497CP	352283	L20X	Nozzle - 1.4 mm HD CP	1
	TR301-1497CPX	352283	L3020X	Nozzle - 1.4 mm HD CP (10 pack)	10

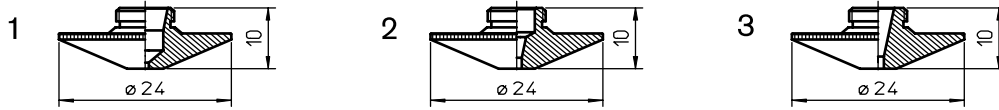

Consumables

	Centricut part number	Reference number	Alternate reference	Description	Pkg qty	
1	TR301-7497-S	237497/S	L258	Nozzle - 1.4 mm HD	1	
	TR301-0497X	237497/S	L30258	Nozzle - 1.4 mm HD (10 pack)	10	
	TR301-7501	237501	L21	Nozzle - 1.7 mm HD	1	
	TR301-7501X	237501	L3021	Nozzle - 1.7 mm HD (10 pack)	10	
	TR301-3211	237502	L168	Nozzle - 2.0 mm HD	1	
	TR301-3211X	237502	L30168	Nozzle - 2.0 mm HD (10 pack)	10	
	TR301-6933	126933	L76	Nozzle - 2.3 mm HD	1	
	TR301-6933X	126933	L3076	Nozzle - 2.3 mm HD (10 pack)	10	
	TR301-0003		L185	Nozzle - 2.5 mm HD	1	
	TR301-0003X		L30185	Nozzle - 2.5 mm HD (10 pack)	10	
	TR301-2742	942742	L360	Nozzle - 2.7 mm HD	1	
	TR301-2742X	942742	L30360	Nozzle - 2.7 mm HD (10 pack)	10	
	TR301-0004		L396	Nozzle - 3.0 mm HD	1	
	TR301-0004X		L30396	Nozzle - 3.0 mm HD (10 pack)	10	
	TR301-0497CP	237497/S	L258X	Nozzle - 1.4 mm HD CP	1	
	TR301-0497CPX		L30258X	Nozzle - 1.4 mm HD CP (10 pack)	10	
	TR301-0501CP	352284	L21X	Nozzle - 1.7 mm HD CP	1	
	TR301-0501CPX	352284	L3021X	Nozzle - 1.7 mm HD CP (10 pack)	10	
	TR301-1002CP	352287	L168X	Nozzle - 2.0 mm HD CP	1	
	TR301-1002CPX	352287	L30168X	Nozzle - 2.0 mm HD CP (10 pack)	10	
	TR301-0933CP	352285	L76X	Nozzle - 2.3 mm HD CP	1	
	TR301-0933CPX	352285	L3076X	Nozzle - 2.3 mm HD CP (10 pack)	10	
	TR301-0003CP		L185X	Nozzle - 2.5 mm HD CP	1	
	TR301-0003CPX		L30185X	Nozzle - 2.5 mm HD CP (10 pack)	10	
	TR301-0742CP	352286	L360X	Nozzle - 2.7 mm HD CP	1	
	TR301-0742CPX	352286	L30360X	Nozzle - 2.7 mm HD CP (10 pack)	10	
	TR301-1004CP		L396X	Nozzle - 3.0 mm HD CP	1	
	TR301-1004CPX		L30396X	Nozzle - 3.0 mm HD CP (10 pack)	10	
	2	TR301-7773	1277773	L1550	Nozzle - 0.8 mm	1
		TR301-7771	1277771	L1551	Nozzle - 1.0 mm	1
		TR301-7774	1277774	L1552	Nozzle - 1.2 mm	1
		TR301-7776	1277776	L1553	Nozzle - 1.4 mm	1
TR301-7779		1277779	L1554	Nozzle - 1.7 mm	1	
TR301-7780		1277780	L1555	Nozzle - 2.0 mm	1	
TR301-7781		1277781	L1556	Nozzle - 2.3 mm	1	
TR301-7782		1277782	L1557	Nozzle - 2.7 mm	1	
TR301-7773CP			L1550X	Nozzle - 0.8 mm CP	1	
TR301-7771CP			L1551X	Nozzle - 1.0 mm CP	1	
TR301-7774CP			L1552X	Nozzle - 1.2 mm CP	1	
TR301-7776CP			L1553X	Nozzle - 1.4 mm CP	1	
TR301-7779CP			L1554X	Nozzle - 1.7 mm CP	1	
TR301-7780CP			L1555X	Nozzle - 2.0 mm CP	1	
TR301-7781CP			L1556X	Nozzle - 2.3 mm CP	1	
TR301-7782CP			L1557X	Nozzle - 2.7 mm CP	1	

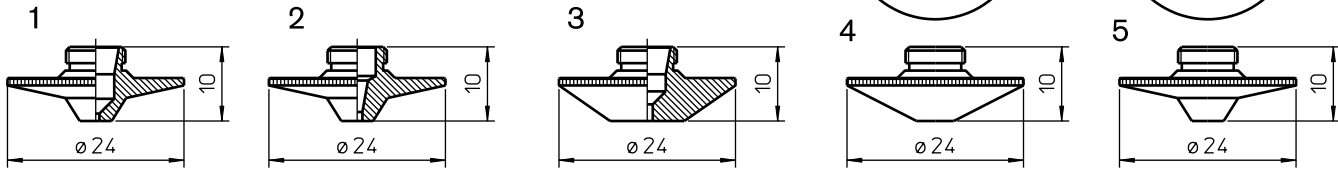

Consumables

	Centricut part number	Reference number	Alternate reference	Description	Pkg qty
1	TR301-4561CP	352280	L18XH	Nozzle - 0.8 mm hard CP	1
	TR301-4561CPX	352280	L3018XH	Nozzle - 0.8 mm hard CP (10 pack)	10
	TR301-4562CP	352281	L19XH	Nozzle - 1.0 mm hard CP	1
	TR301-4562CPX	352281	L3019XH	Nozzle - 1.0 mm hard CP (10 pack)	10
	TR301-6809CP	352282	L361XH	Nozzle - 1.2 mm hard CP	1
	TR301-6809CPX	352282	L30361XH	Nozzle - 1.2 mm hard CP (10 pack)	10
2	TR301-7497CP	352283	L20XH	Nozzle - 1.4 mm HD hard CP	1
	TR301-7497CPX	352283	L3020XH	Nozzle - 1.4 mm HD hard CP (10 pack)	10
3	TR301-0014HCP		L258XH	Nozzle - 1.4 mm HD hard CP	1
	TR301-0014HCPX		L30258XH	Nozzle - 1.4 mm HD hard CP (10 pack)	10
	TR301-7501CP	352284	L21XH	Nozzle - 1.7 mm HD hard CP	1
	TR301-7501CPX	352284	L3021XH	Nozzle - 1.7 mm HD hard CP (10 pack)	10
	TR301-0002CP	352287	L168XH	Nozzle - 2.0 mm HD hard CP	1
	TR301-0002CPX	237502	L30168XH	Nozzle - 2.0 mm HD hard CP (10 pack)	10
	TR301-6933CP	352285	L76XH	Nozzle - 2.3 mm HD hard CP	1
	TR301-6933CPX	352285	L3076XH	Nozzle - 2.3 mm HD hard CP (10 pack)	10
	TR301-0025HCP		L185XH	Nozzle - 2.5 mm HD hard CP	1
	TR301-0025HCPX		L30185XH	Nozzle - 2.5 mm HD hard CP (10 pack)	10
	TR301-2742CP	352286	L360XH	Nozzle - 2.7 mm HD hard CP	1
	TR301-2742CPX	352286	L30360XH	Nozzle - 2.7 mm HD hard CP (10 pack)	10
	TR301-0004CP		L396XH	Nozzle - 3.0 mm HD hard CP	1
	TR301-0004CPX		L30396XH	Nozzle - 3.0 mm HD hard CP (10 pack)	10

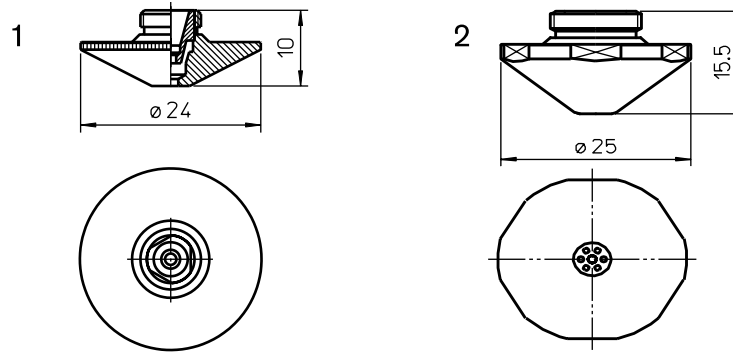

Consumables

	Centricut part number	Reference number	Alternate reference	Description	Pkg qty
1	TR301-5780	215780	L2	Nozzle - 0.8 mm	1
	TR301-5780X	215780	L3002	Nozzle - 0.8 mm (10 pack)	10
	TR301-7658	87658	L11	Nozzle - 1.0 mm	1
	TR301-7658X	87658	L3011	Nozzle - 1.0 mm (10 pack)	10
	TR301-5780CP	215780	L2X	Nozzle - 0.8 mm CP	1
	TR301-5780CPX	215780	L3002X	Nozzle - 0.8 mm CP (10 pack)	10
	TR301-7658CP	87658	L11X	Nozzle - 1.0 mm CP	1
	TR301-7658CPX	87658	L3011X	Nozzle - 1.0 mm CP (10 pack)	10
2	TR301-8894	88894	L1	Nozzle - 1.4 mm HD	1
	TR301-8894X	88894	L3001	Nozzle - 1.4 mm HD (10 pack)	10
	TR301-7867	217867	L12	Nozzle - 1.7 mm HD	1
	TR301-7867X	217867	L3012	Nozzle - 1.7 mm HD (10 pack)	10
3	TR301-1010		L798	Nozzle - 1.0 mm	1
	TR301-1010X		L30798	Nozzle - 1.0 mm (10 pack)	10
	TR301-8893	88893	L13	Nozzle - 1.5 mm	1
	TR301-8893X	88893	L3013	Nozzle - 1.5 mm (10 pack)	10
	TR301-1781	221781	L68	Nozzle - 2.0 mm	1
	TR301-1781X	221781	L3068	Nozzle - 2.0 mm (10 pack)	10
	TR301-4565	235592	L230	Nozzle - 3.0 mm	1
	TR301-4565X	235592	L30230	Nozzle - 3.0 mm (10 pack)	10
4	TR301-7872	237872	L495	Shower nozzle - 0.8 mm	1
	TR301-7872X	237872	L30495	Shower nozzle - 0.8 mm (10 pack)	10
5	TR301-7976	217976	L496	Shower nozzle - 0.8 mm	1
	TR301-7976X	217976	L30496	Shower nozzle - 0.8 mm (10 pack)	10

Consumables

	Centricut part number	Reference number	Alternate reference	Description	Pkg qty
1	TR355-0005	Centricut design	L640	Nozzle - 0.8 mm double	1
	TR355-0005X	Centricut design	L30640	Nozzle - 0.8 mm double (10 pack)	10
	TR355-0001	Centricut design	L641	Nozzle - 1.0 mm double	1
	TR355-0001X	Centricut design	L30641	Nozzle - 1.0 mm double (10 pack)	10
	TR355-0006	Centricut design	L648	Nozzle - 1.2 mm double	1
	TR355-0006X	Centricut design	L30648	Nozzle - 1.2 mm double (10 pack)	10
	TR355-0002	Centricut design	L642	Nozzle - 1.4 mm double	1
	TR355-0002X	Centricut design	L30642	Nozzle - 1.4 mm double (10 pack)	10
	TR355-0003	Centricut design	L643	Nozzle - 1.7 mm double	1
	TR355-0003X	Centricut design	L30643	Nozzle - 1.7 mm double (10 pack)	10
	TR355-0007	Centricut design	L644	Nozzle - 2.0 mm double	1
	TR355-0007X	Centricut design	L30644	Nozzle - 2.0 mm double (10 pack)	10
	TR355-0004	Centricut design	L645	Nozzle - 2.3 mm double	1
	TR355-0004X	Centricut design	L30645	Nozzle - 2.3 mm double (10 pack)	10
	TR355-0008	Centricut design	L646	Nozzle - 2.7 mm double	1
	TR355-0008X	Centricut design	L30646	Nozzle - 2.7 mm double (10 pack)	10
	TR355-0009	Centricut design	L647	Nozzle - 3.0 mm double	1
	TR355-0009X	Centricut design	L30647	Nozzle - 3.0 mm double (10 pack)	10
	TR355-0010	Centricut design	L649	Nozzle - 4.0 mm double	1
	TR355-0010X	Centricut design	L30649	Nozzle - 4.0 mm double (10 pack)	10
	TR355-0005CP	Centricut design	L640X	Nozzle - 0.8 mm double CP	1
	TR355-0005CPX	Centricut design	L30640X	Nozzle - 0.8 mm double CP (10 pack)	10
	TR355-0001CP	Centricut design	L641X	Nozzle - 1.0 mm double CP	1
	TR355-0001CPX	Centricut design	L30641X	Nozzle - 1.0 mm double CP (10 pack)	10
	TR355-0006CP	Centricut design	L648X	Nozzle - 1.2 mm double CP	1
	TR355-0006CPX	Centricut design	L30648X	Nozzle - 1.2 mm double CP (10 pack)	10
	TR355-0002CP	Centricut design	L642X	Nozzle - 1.4 mm double CP	1
	TR355-0002CPX	Centricut design	L30642X	Nozzle - 1.4 mm double CP (10 pack)	10
	TR355-0003CP	Centricut design	L643X	Nozzle - 1.7 mm double CP	1
	TR355-0003CPX	Centricut design	L30643X	Nozzle - 1.7 mm double CP (10 pack)	10
	TR355-0007CP	Centricut design	L644X	Nozzle - 2.0 mm double CP	1
	TR355-0007CPX	Centricut design	L30644X	Nozzle - 2.0 mm double CP (10 pack)	10
	TR355-0004CP	Centricut design	L645X	Nozzle - 2.3 mm double CP	1
	TR355-0004CPX	Centricut design	L30645X	Nozzle - 2.3 mm double CP (10 pack)	10
TR355-0008CP	Centricut design	L646X	Nozzle - 2.7 mm double CP	1	
TR355-0008CPX	Centricut design	L30646X	Nozzle - 2.7 mm double CP (10 pack)	10	
TR355-0009CP	Centricut design	L647X	Nozzle - 3.0 mm double CP	1	
TR355-0009CPX	Centricut design	L30647X	Nozzle - 3.0 mm double CP (10 pack)	10	
TR355-0010CP	Centricut design	L649X	Nozzle - 4.0 mm double CP	1	
TR355-0010CPX	Centricut design	L30649X	Nozzle - 4.0 mm double CP (10 pack)	10	
2	TR426-6012		L1281	Shower nozzle - 1.2 mm	1
	TR426-6012X		L501281	Shower nozzle - 1.2 mm (10 pack)	10

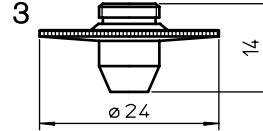
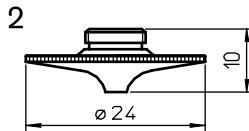
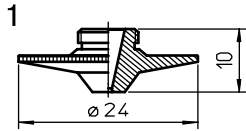
Centricut is not affiliated with the named manufacturers. Reference to machines, parts, descriptions, and model numbers are for convenience in verifying compatibility only. All parts are made by or for Centricut and are not made by the referenced manufacturers (unless expressly indicated). Centricut is a registered trademark of Hypertherm, Inc. All other trademarks are the properties of their respective owners.

Consumables

	Centricut part number	Reference number	Alternate reference	Description	Pkg qty
1	TR412-0008	Centricut design	L226	Nozzle - 0.8 mm HD	1
	TR412-0008X	Centricut design	L30226	Nozzle - 0.8 mm HD (10 pack)	10
	TR412-0010	Centricut design	L181	Nozzle - 1.0 mm HD	1
	TR412-0010X	Centricut design	L30181	Nozzle - 1.0 mm HD (10 pack)	10
	TR412-0014	Centricut design	L182	Nozzle - 1.4 mm HD	1
	TR412-0014X	Centricut design	L30182	Nozzle - 1.4 mm HD (10 pack)	10
	TR412-0017	Centricut design	L227	Nozzle - 1.7 mm HD	1
	TR412-0017X	Centricut design	L30227	Nozzle - 1.7 mm HD (10 pack)	10
	TR301-0001	Centricut design	L313	Nozzle - 2.3 mm HD	1
TR301-0001X	Centricut design	L30313	Nozzle - 2.3 mm HD (10 pack)	10	
2	TR412-0023	Centricut design	L720	Nozzle - 2.3 mm HD	1
	TR412-0023X	Centricut design	L30720	Nozzle - 2.3 mm HD (10 pack)	10
	TR412-0025	Centricut design	L721	Nozzle - 2.5 mm HD	1
	TR412-0025X	Centricut design	L30721	Nozzle - 2.5 mm HD (10 pack)	10
	TR412-0027	Centricut design	L722	Nozzle - 2.7 mm HD	1
	TR412-0027x	Centricut design	L30722	Nozzle - 2.7 mm HD (10 pack)	10
	TR412-1014CP	Centricut design	L1034X	Nozzle - 1.4 mm HD CP	1
	TR412-1014CPX	Centricut design	L301034X	Nozzle - 1.4 mm HD CP (10 pack)	10
	TR412-1017CP	Centricut design	L1035X	Nozzle - 1.7 mm HD CP	1
	TR412-1017CPX	Centricut design	L301035X	Nozzle - 1.7 mm HD CP (10 pack)	10
	TR412-1023CP	Centricut design	L720X	Nozzle - 2.3 mm HD CP	1
	TR412-1023CPX	Centricut design	L30720X	Nozzle - 2.3 mm HD CP (10 pack)	10
	TR412-1025CP	Centricut design	L721X	Nozzle - 2.5 mm HD CP	1
	TR412-1025CPX	Centricut design	L30721X	Nozzle - 2.5 mm HD CP (10 pack)	10
	TR412-1027CP	Centricut design	L722X	Nozzle - 2.7 mm HD CP	1
	TR412-1027CPX	Centricut design	L30722X	Nozzle - 2.7 mm HD CP (10 pack)	10
TR415-0008	Centricut design	L200	Nozzle - 0.8 mm extended	1	
TR415-0010	Centricut design	L199	Nozzle - 1.0 mm extended	1	
3	TR415-0012	Centricut design	L657	Nozzle - 1.2 mm extended	1
	TR415-0014	Centricut design	L658	Nozzle - 1.4 mm extended	1
	TR415-0016	Centricut design	L670	Nozzle - 1.6 mm extended	1
	TR415-0017	Centricut design	L659	Nozzle - 1.7 mm extended	1
	TR415-0016	Centricut design	L670	Nozzle - 1.6 mm extended	1
	TR415-0017	Centricut design	L659	Nozzle - 1.7 mm extended	1

Centricut is not affiliated with the named manufacturers. Reference to machines, parts, descriptions, and model numbers are for convenience in verifying compatibility only. All parts are made by or for Centricut and are not made by the referenced manufacturers (unless expressly indicated). Centricut is a registered trademark of Hypertherm, Inc. All other trademarks are the properties of their respective owners.

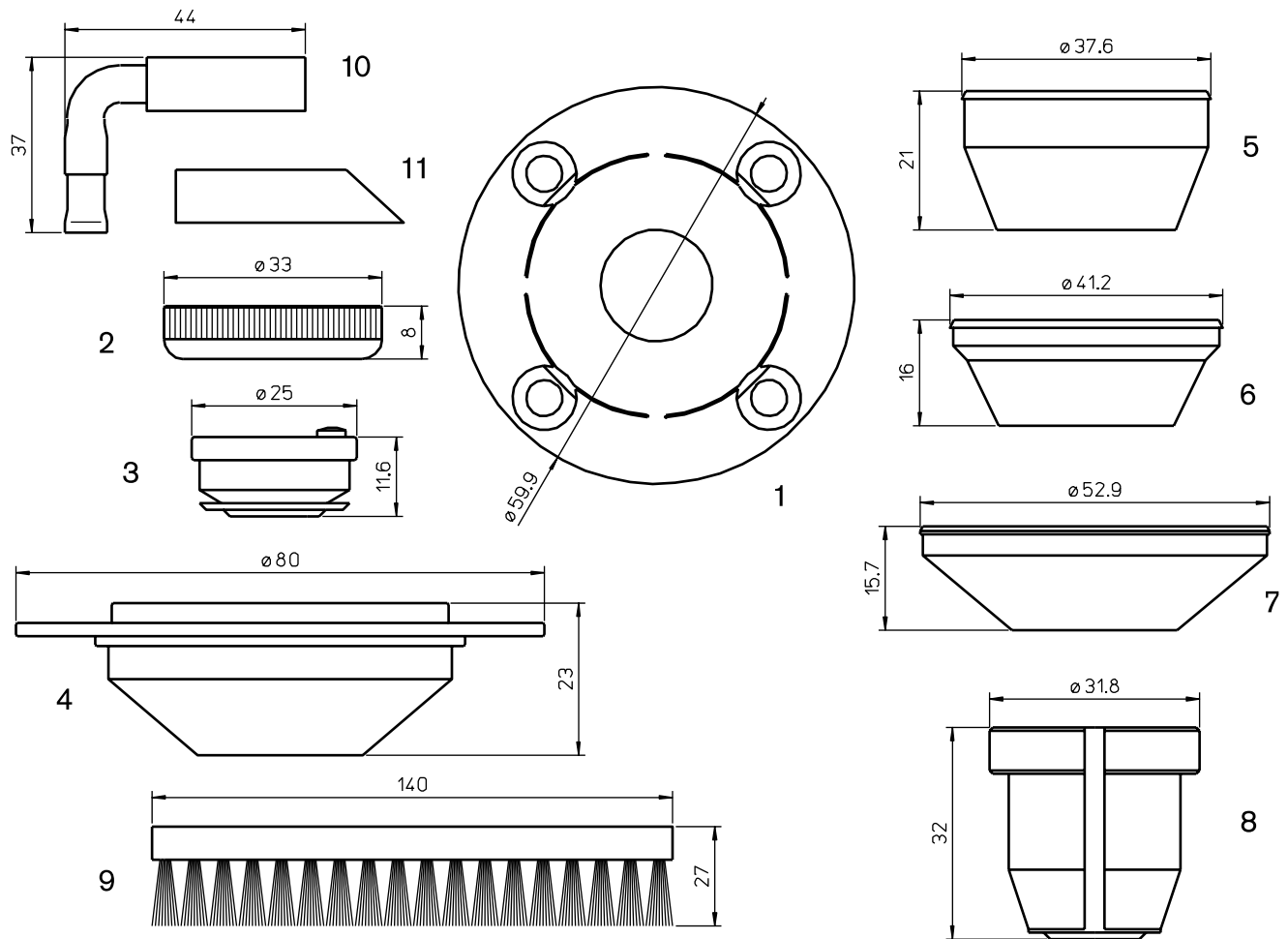

Consumables

	Centricut part number	Reference number	Alternate reference	Description	Pkg qty
1	TR301-4485	234485	AL70	Break-away plate	1
2	TR301-6066	216066	AL250	Signboard	1
3	TR301-8809	258809, 243839, 247894	AL38	Nozzle holder - ceramic	1
	TR301-8809OEM		AL400	Nozzle holder - ceramic (OEM)	1
4	TR301-6065	216065	AL19	Cover, PTFE*	1
5	TR301-6153	256153, 955826	AL47	Cover, PTFE* (white)	1
	TR301-6153T	256153, 955826	AL347	Cover, PTFE* (black)	1
6	TR301-4496	254496	AL36	Cover, PTFE*	1
7	TR301-5286	225286	AL41	Cover, PTFE*	1
8	TR301-0432	254493, 260432	AL108	Nozzle holder - ceramic	1
9	TR301-3202	0353202, 900594	AL272	Brush	1
10	TR301-8557	88557	88557	Nozzle - 90 degrees	1
11	TR301-6184	256184	256184	Blow tube	1

*PolyTetraFluoroEthylene is a fluorocarbon-based polymer and is commonly abbreviated PTFE. The Teflon® brand of PTFE is manufactured only by DuPont and is not sold by Hypertherm. Hypertherm purchases other brands of PTFE from various high quality manufacturers.

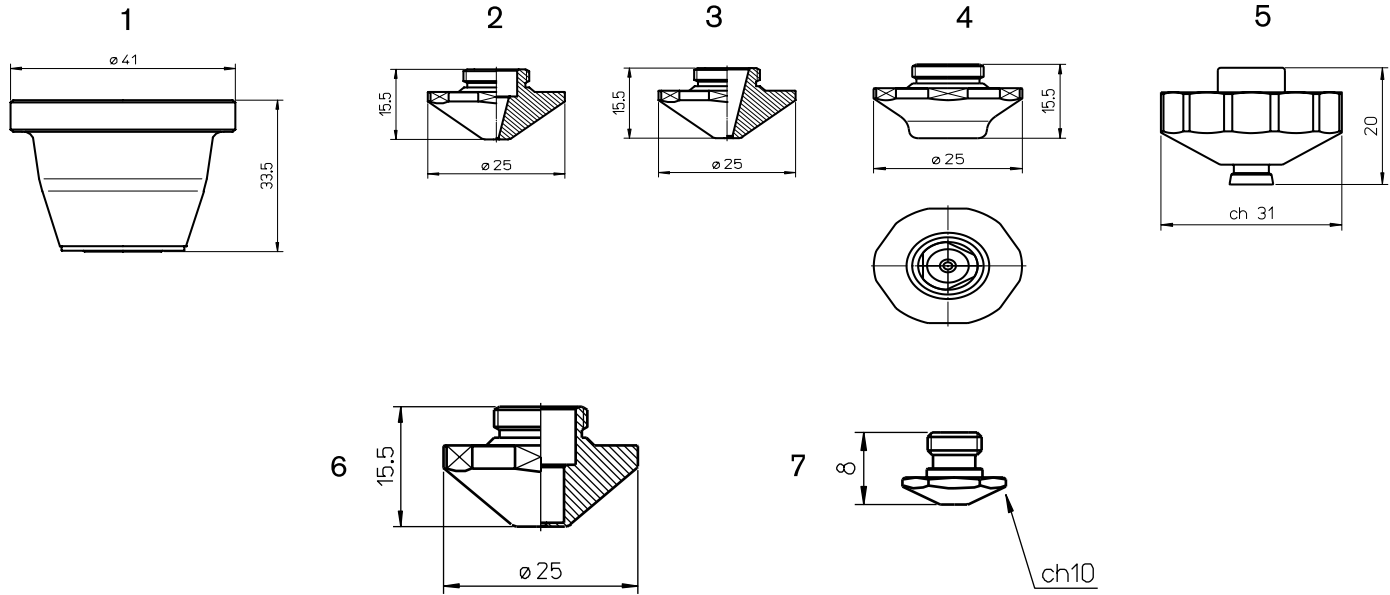
Consumables

	Centricut part number	Reference number	Alternate reference	Description	Pkg qty
1	TR407-5673	1349171, 1755673	AL410	Nozzle holder - ceramic	1
2	TR407-4858	1324858	L1270	Nozzle - 0.8 mm	1
	TR407-4858X	1324858	L501270	Nozzle - 0.8 mm (10 pack)	10
	TR407-4860	1324860	L1272	Nozzle - 1.0 mm	1
	TR407-4860X	1324860	L501272	Nozzle - 1.0 mm (10 pack)	10
	TR407-4861	1324861	L1273	Nozzle - 1.2 mm	1
	TR407-4861X	1324861	L501273	Nozzle - 1.2 mm (10 pack)	10
	TR407-4863	1324863	L1275	Nozzle - 1.4 mm	1
	TR407-4863X	1324863	L501275	Nozzle - 1.4 mm (10 pack)	10
	TR407-4864	1324864	L1276	Nozzle - 1.7 mm	1
	TR407-4864X	1324864	L501276	Nozzle - 1.7 mm (10 pack)	10
	TR407-4858CPH	1324858	L1270XH	Nozzle - 0.8 mm hard CP	1
	TR407-4858CPHX	1324858	L501270XH	Nozzle - 0.8 mm hard CP (10 pack)	10
	TR407-4860CPH	1324860	L1272XH	Nozzle - 1.0 mm hard CP	1
	TR407-4860CPHX	1324860	L501272XH	Nozzle - 1.0 mm hard CP (10 pack)	10
	TR407-4861CPH	1324861	L1273XH	Nozzle - 1.2 mm hard CP	1
	TR407-4861CPHX	1324861	L501273XH	Nozzle - 1.2 mm hard CP (10 pack)	10
	TR407-4863CPH	1324863	L1275XH	Nozzle - 1.4 mm hard CP	1
	TR407-4863CPHX	1324863	L501275XH	Nozzle - 1.4 mm hard CP (10 pack)	10
	TR407-4864CPH	1324864	L1276XH	Nozzle - 1.7 mm hard CP	1
TR407-4864CPHX	1324864	L501276XH	Nozzle - 1.7 mm hard CP (10 pack)	10	
3	TR407-4865	1324865	L1277	Nozzle - 2.0 mm	1
	TR407-4865X	1324865	L501277	Nozzle - 2.0 mm (10 pack)	10
	TR407-4866	1324866	L1278	Nozzle - 2.3 mm	1
	TR407-4866X	1324866	L501278	Nozzle - 2.3 mm (10 pack)	10
	TR407-4867	1324867	L1279	Nozzle - 2.7 mm	1
	TR407-4867X	1324867	L501279	Nozzle - 2.7 mm (10 pack)	10
	TR407-4865CPH	1324865	L1277XH	Nozzle - 2.0 mm hard CP	1
	TR407-4865CPHX	1324865	L501277XH	Nozzle - 2.0 mm hard CP (10 pack)	10
	TR407-4866CPH	1324866	L1278XH	Nozzle - 2.3 mm hard CP	1
	TR407-4866CPHX	1324866	L501278XH	Nozzle - 2.3 mm hard CP (10 pack)	10
	TR407-4867CPH	1324867	L1279XH	Nozzle - 2.7 mm hard CP	1
	TR407-4867CPHX	1324867	L501279XH	Nozzle - 2.7 mm hard CP (10 pack)	10

Consumables

	Centricut part number	Reference number	Alternate reference	Description	Pkg qty
4	TR407-9091	1809091	L1885	Nozzle – Double 6.0 mm	1
	TR407-9421	1809421	L1886	Nozzle – Double 7.5 mm	1
	TR407-6199	1886199	L1887	Nozzle – Double 9.5 mm	1
5	TR407-4018	1774018	L1800	Nozzle – 1.4 mm	1
	TR407-8745	1838745	L1801	Nozzle – 1.7 mm	1
	TR407-4020	1774020	L1802	Nozzle – 2.0 mm	1
	TR407-4092	1774092	L1803	Nozzle – 2.3 mm	1
6	TR407-7264 NEW	ZAA-01, 1637264	L1260	Nozzle – focusing	1
7	TR407-9610 NEW	1589610	L1700	Nozzle – 2.0 mm blow off	1

Centricut is not affiliated with the named manufacturers. Reference to machines, parts, descriptions, and model numbers are for convenience in verifying compatibility only. All parts are made by or for Centricut and are not made by the referenced manufacturers (unless expressly indicated). Centricut is a registered trademark of Hypertherm, Inc. All other trademarks are the properties of their respective owners.

1

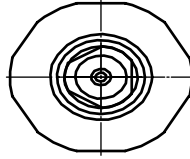
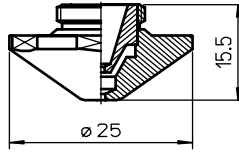
Consumables

	Centricut part number	Reference number	Alternate reference	Description	Pkg qty
	TR426-1308		L1308	Nozzle - 0.8 mm double	1
	TR426-1308X		L501308	Nozzle - 0.8 mm double (10 pack)	10
	TR426-1309		L1309	Nozzle - 1.0 mm double	1
	TR426-1309X		L501309	Nozzle - 1.0 mm double (10 pack)	10
	TR426-1310		L1310	Nozzle - 1.2 mm double	1
	TR426-1310X		L501310	Nozzle - 1.2 mm double (10 pack)	10
	TR426-1311		L1311	Nozzle - 1.4 mm double	1
	TR426-1311X		L501311	Nozzle - 1.4 mm double (10 pack)	10
	TR426-1312		L1312	Nozzle - 1.7 mm double	1
	TR426-1312X		L501312	Nozzle - 1.7 mm double (10 pack)	10
	TR426-1308CPH		L1308XH	Nozzle - 0.8 mm double hard CP	1
	TR426-1308CPHX		L501308XH	Nozzle - 0.8 mm double hard CP (10 pack)	10
	TR426-1309CPH		L1309XH	Nozzle - 1.0 mm double hard CP	1
	TR426-1309CPHX		L501309XH	Nozzle - 1.0 mm double hard CP (10 pack)	10
	TR426-1310CPH		L1310XH	Nozzle - 1.2 mm double hard CP	1
	TR426-1310CPHX		L501310XH	Nozzle - 1.2 mm double hard CP (10 pack)	10
1	TR426-1311CPH		L1311XH	Nozzle - 1.4 mm double hard CP	1
	TR426-1311CPHX		L501311XH	Nozzle - 1.4 mm double hard CP (10 pack)	10
	TR426-1312CPH		L1312XH	Nozzle - 1.7 mm double hard CP	1
	TR426-1312CPHX		L501312XH	Nozzle - 1.7 mm double hard CP (10 pack)	10
	TR426-1313		L1313	Nozzle - 2.0 mm double	1
	TR426-1313X		L501313	Nozzle - 2.0 mm double (10 pack)	10
	TR426-1314		L1314	Nozzle - 2.3 mm double	1
	TR426-1314X		L501314	Nozzle - 2.3 mm double (10 pack)	10
	TR426-1315		L1315	Nozzle - 2.7 mm double	1
	TR426-1315X		L501315	Nozzle - 2.7 mm double (10 pack)	10
	TR426-1313CPH		L1313XH	Nozzle - 2.0 mm double hard CP	1
	TR426-1313CPHX		L501313XH	Nozzle - 2.0 mm double hard CP (10 pack)	10
	TR426-1314CPH		L1314XH	Nozzle - 2.3 mm double hard CP	1
	TR426-1314CPHX		L501314XH	Nozzle - 2.3 mm double hard CP (10 pack)	10
	TR426-1315CPH		L1315XH	Nozzle - 2.7 mm double hard CP	1
	TR426-1315CPHX		L501315XH	Nozzle - 2.7 mm double hard CP (10 pack)	10



Consumables

	Centricut part number	Reference number	Alternate reference	Description	Pkg qty
1	TR426-3325	1373325	L1501	Nozzle - 1.0 mm	1
	TR426-3325X	1373325	L501501	Nozzle - 1.0 mm (10 pack)	10
	TR426-3326	1373326	L1502	Nozzle - 1.2 mm	1
	TR426-3326X	1373326	L501502	Nozzle - 1.2 mm (10 pack)	10
	TR426-3327	1373327	L1503	Nozzle - 1.4 mm	1
	TR426-3327X	1373327	L501503	Nozzle - 1.4 mm (10 pack)	10
	TR426-3328	1373328	L1504	Nozzle - 1.7 mm	1
	TR426-3328X	1373328	L501504	Nozzle - 1.7 mm (10 pack)	10
2	TR426-3324	1373324	L1500	Nozzle - 0.8 mm	1
	TR426-3324X	1373324	L501500	Nozzle - 0.8 mm (10 pack)	10
	TR426-3329	1373329	L1505	Nozzle - 2.0 mm	1
	TR426-3329X	1373329	L501505	Nozzle - 2.0 mm (10 pack)	10
	TR426-3330	1373330	L1506	Nozzle - 2.3 mm	1
	TR426-3330X	1373330	L501506	Nozzle - 2.3 mm (10 pack)	10
	TR426-3331	1373331	L1507	Nozzle - 2.7 mm	1
	TR426-3331X	1373331	L501507	Nozzle - 2.7 mm (10 pack)	10

Centricut is not affiliated with the named manufacturers. Reference to machines, parts, descriptions, and model numbers are for convenience in verifying compatibility only. All parts are made by or for Centricut and are not made by the referenced manufacturers (unless expressly indicated). Centricut is a registered trademark of Hypertherm, Inc. All other trademarks are the properties of their respective owners.

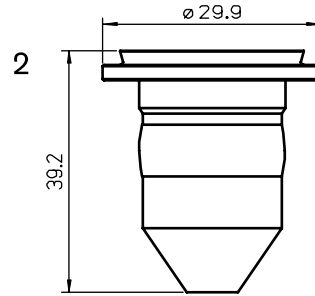
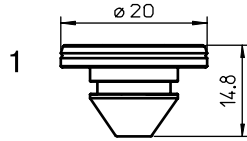
Consumables

	Centricut part number	Reference number	Alternate reference	Description	Pkg qty
1	TR303-2952	202952	L5	Nozzle - 0.8 mm HP	1
	TR303-0969	218969	L34	Nozzle - 1.0 mm HP	1
	TR303-9402	209402	L35	Nozzle - 1.4 mm HP	1
	TR303-7953	217953	L36	Nozzle - 1.7 mm HP	1
2	TR304-0653-08	60653	L217	Nozzle - 0.8 mm	1
	TR304-0653-3	60653	L218	Nozzle - 1.0 mm	1
	TR304-0653-14	60653	L219	Nozzle - 1.4 mm	1
Filters - not shown					
	TR301-2380	92380	FT1	Filter DX	1
	TR301-2381	92381	FT2	Filter BX	1
	TR301-2379	92379	FT3	Filter CI	1
	TR301-3676	123676 - U0310 VF	FT4	Filter	1
	TR301-3675	123675 - U0310 SMA	FT5	Filter	1
	TR301-3674	123674 - U0310 CA	FT6	Filter	1
	TR301-6152	146152	CP10	Filter	1
	TR301-5942	0115942		Filter	1

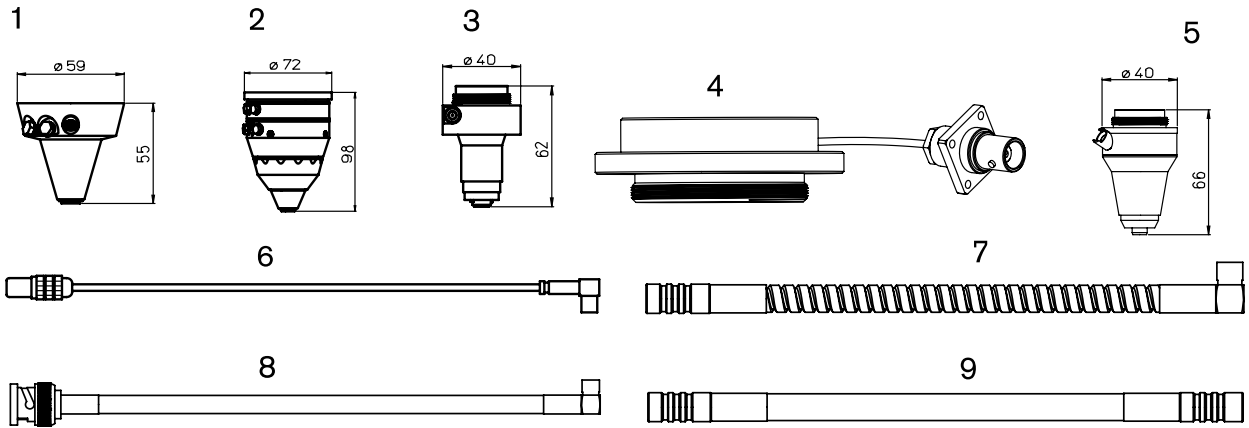

Consumables

	Centricut part number	Reference number	Alternate reference	Description	Pkg qty
1	PT999-YH27	562313		Sensor repair YH27	1
2	PT999-YR30	YR-30		Sensor repair YR30	1
3	TR999-3963	913963		Sensor repair 913963 (Slim)	1
4	TR999-8351	938351	9392-850	Sensor repair - Trumatic	1
5	PT999-KN	280549		Sensor repair KN	1
6	TR301-1086	0351086, P0492-001-00000	351086	Sensor cable	1
7	TR301-9983	359983		Sensor cable - armored 190 mm (7.5")	1
8	TR301-7833	227833		Sensor cable - armored 432 mm (17")	1
9	TR301-0930	280930		Sensor cable - armored 152 mm (6")	1

Sensor repairs available in select regions only.

Optics

Centricut part number	Reference number	Type	Diameter	Focal length	Edge thickness
Lenses					
TR300-6104	346104	MEN	1.5"	3.75"	.290"
TR300-8114	88114	MEN	1.5"	5.0"	.290"
TR300-0002	706491	MEN	1.5"	5.0"	.157"
TR300-7517	97517	MEN	1.5"	7.5"	.290"
TR300-8123	581123	MEN	1.575" (40 mm)	6.102" (155 mm)	.295" (7.5 mm)
TR300-1972	141972	MEN	1.5"	9.0"	.290"
TR300-0163	350163	MEN	1.5"	10.0"	.290"
TR300-6477	726477	MEN	1.5"	10.0"	.354"
TR300-0170	500170LMA	MEN - CUT	1.969" (50mm)	6.7" (170 mm)	.350" (8.9 mm)
TR300-0175	500175LMA	MEN - CUT	1.969" (50mm)	6.89" (175 mm)	.350" (8.9 mm)
TR300-6128	1766128, 6055298	MEN - CHIP/CUT	1.969" (50mm)	9.842" (250 mm)	.350" (8.9 mm)
TR300-5719	1795719, 6055341	MEN - CHIP/CUT	1.969" (50mm)	6.89" (175 mm)	.350" (8.9 mm)
TR300-0130	400130LMA	MEN - CUT	1.575" (40mm)	5.118" (130 mm)	.295" (7.5 mm)
TR300-0250	0380115, 400250LMA	MEN - CUT	1.575" (40mm)	9.842" (250 mm)	.295" (7.5 mm)
TR300-2500		MEN - CUT	1.969" (50mm)	9.842" (250 mm)	.350" (8.9 mm)
TR300-0115		MEN - CUT	1.969" (50mm)	4.528" (115 mm)	.350" (8.9 mm)
TR300-0805	1770805, 933019LMC	MEN - CHIP/CUT	1.575" (40mm)	9.842" (250 mm)	.295" (7.5 mm)
TR300-2319	1772319, 232114LMC	MEN - CHIP/CUT	1.575" (40mm)	5.118" (130 mm)	.295" (7.5 mm)
Low absorption lenses					
TR300-8114MP5	88114	MEN	1.5"	5.0"	.290"
TR300-7517MP5	97517	MEN	1.5"	7.5"	.290"

Centricut is not affiliated with the named manufacturers. Reference to machines, parts, descriptions, and model numbers are for convenience in verifying compatibility only. All parts are made by or for Centricut and are not made by the referenced manufacturers (unless expressly indicated). Centricut is a registered trademark of Hypertherm, Inc. All other trademarks are the properties of their respective owners.

Optics

Centricut part number	Reference number	Type	Material	Diameter	Focal length	Edge thickness
Fiber laser						
TR300-3107	1603107	PLX	FS	40 mm	150 mm	5.30 mm

Centricut part number	Reference number	Material	Diameter	Edge thickness
Windows				
TR300-4767	1614767	FS	34 mm	5 mm
TR300-6719	766719	FS	30 mm	5 mm

Optics care

Centricut part number	Reference number	Description	Pkg qty
TR300-6452	N/A	Lens cleaning paper, Tiffen – 50 piece	1
AM313-SC50	SC50	Lens cleaning paper, Tresor – 50 piece	1
TR300-1115		Lens cleaning pre-cut cotton – 80 piece	1
TR300-SC20		Cotton swab – 20 piece	1
TR300-1010	AL1010	Dropper, lens cleaning fluid	1
TR300-1112		Optical cleaning fluid	1
TR300-0699	70675699 REVA	Lens Cleaning Swabs (25 pack)	1
TR300-7991	027991	Polyester Wipes 4" x 4"	1
TR301-0282		Injector	1
TR300-LSA		Lens stress analyzer	1
TR300-255	AL255	Loupe, magnifying	1
TR300-271	AL271	Base, lens maintenance	1
TR300-7388	787388	Mirror polish (250 ml)	1
TR300-7388	787388	Mirror polish (250 ml)	1
TR300-115	ALI115	Indium wire – 1.0 mm x 125 mm (1.5" lens)	1

Technical support

- Our technical service team can answer questions about any laser or plasma cutting system. Whether it's a question about a part, a system, or for guidance on how to optimize performance, our experts can help.
- We stand behind our products with industry-leading technical expertise
- OEM trained technicians on staff with over 25 years experience



**HELPING YOU
SHAPE THE WORLD.**



PLASMA | LASER | WATERJET | AUTOMATION | SOFTWARE | CONSUMABLES

For more information on Centricut laser products, visit
www.hypertherm.com/centricut/laser

Hypertherm, Centricut, SilverLine and CoolFlow are trademarks of Hypertherm Inc., and may be registered in the United States and/or other countries. All other trademarks are the property of their respective owners.

One of Hypertherm's long-standing core values is a focus on minimizing our impact on the environment. Doing so is critical to our, and our customers' success. We are always striving to become better environmental stewards; it is a process we care deeply about.

© 12/2016 Hypertherm Inc.



Hypertherm[®]
SHAPING POSSIBILITY™

